

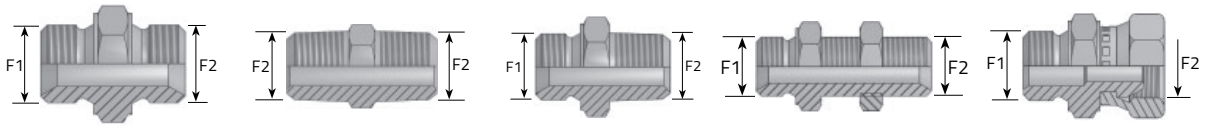

## ADATTATORI GAS/GAS

disponibili anche INOX

SERIE STANDARD



FILETTO		NIPLES DIRITTO M GAS CIL SV 60° M GAS CIL SV 60°		NIPLES DIRITTO M GAS CON SV 60° M GAS CON SV 60°		NIPLES DIRITTO M GAS CIL SV 60° M GAS CONICO		NIPLES PASSAPARETE M CIL SV 60° M CIL SV 60°		NIPLES DRITTO M GAS CIL SV 60° F GAS GIREVOLE CIL	
F1	F2	Codice	€	Codice	€	Codice	€	Codice	€	Codice	€
1/8"	1/8"	ANGG0202	1,158	ANKK0202	1,552	ANGK0202	1,596			AMFDG0202	3,403
1/4"	1/4"	ANGG0404	1,113	ANKK0404	1,666	ANGK0404	1,425	ANGG0404P	7,142	AMFDG0404	2,779
1/4"	3/8"					ANGK0406	1,819				
1/4"	1/2"					ANGK0408	3,072				
3/8"	3/8"	ANGG0606	1,456	ANKK0606	2,595	ANGK0606	2,239	ANGG0606P	8,204	AMFDG0606	3,345
3/8"	1/2"					ANGK0608	2,283				
1/2"	1/2"	ANGG0808	2,112	ANKK0808	3,574	ANGK0808	3,129	ANGG0808P	10,411	AMFDG0808	5,050
5/8"	5/8"	ANGG1010	3,638			ANGK1010	-			AMFDG1010	7,282
3/4"	3/4"	ANGG1212	3,225	ANKK1212	4,776	ANGK1212	5,005	ANGG1212P	18,380	AMFDG1212	7,384
1"	1"	ANGG1616	6,163	ANKK1616	7,416	ANGK1616	10,074	ANGG1616P	36,901	AMFDG1616	12,288
1.1/4"	1.1/4"	ANGG2020	13,674	ANKK2020	20,040	ANGK2020	16,797	ANGG2020P	49,691	AMFDG2020	35,622
1.1/2"	1.1/2"	ANGG2424	17,700	ANKK2424	27,208	ANGK2424	22,775	ANGG2424P	74,991	AMFDG2424	47,547
2"	2"	ANGG3232	36,824	ANKK3232	71,277	ANGK3232	42,911	ANGG3232P	130,545	AMFDG3232	77,770

SERIE STANDARD

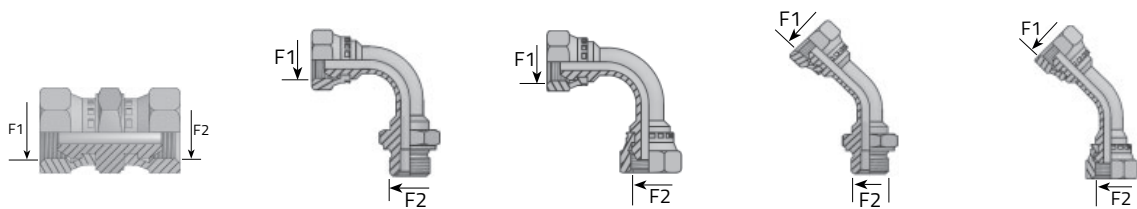

FILETTO		NIPLES DIRITTO F GIR GAS CIL F GIR GAS CIL		CURVA 90° M GAS CIL SV 60° F GIR GAS CIL		CURVA 90° F GIR GAS CIL F GIR GAS CIL		CURVA 45° M GAS CIL SV 60° F GIR GAS CIL		CURVA 45° F GIR GAS CIL F GIR GAS CIL	
F1	F2	Codice	€	Codice	€	Codice	€	Codice	€	Codice	€
1/8"	1/8"	AFFDG0202	3,695	AMF90G0202	8,694	AFF90G0202	10,405	AMF45G0202	10,138	AFF45G0202	10,920
1/4"	1/4"	AFFDG0404	4,929	AMF90G0404	6,614	AFF90G0404	9,025	AMF45G0404	6,977	AFF45G0404	9,025
1/4"	3/8"										
1/4"	1/2"										
3/8"	3/8"	AFFDG0606	5,781	AMF90G0606	8,834	AFF90G0606	10,418	AMF45G0606	8,332	AFF45G0606	9,305
3/8"	1/2"										
1/2"	1/2"	AFFDG0808	7,638	AMF90G0808	11,779	AFF90G0808	13,095	AMF45G0808	12,364	AFF45G0808	13,235
5/8"	5/8"	AFFDG1010	9,858	AMF90G1010	19,048	AFF90G1010	16,523	AMF45G1010	19,443	AFF45G1010	20,759
3/4"	3/4"	AFFDG1212	12,046	AMF90G1212	19,443	AFF90G1212	18,749	AMF45G1212	20,810	AFF45G1212	21,204
1"	1"	AFFDG1616	16,943	AMF90G1616	33,415	AFF90G1616	34,579	AMF45G1616	34,058	AFF45G1616	36,583
1.1/4"	1.1/4"	AFFDG2020	54,855	AMF90G2020	68,306	AFF90G2020	68,465	AMF45G2020	64,579	AFF45G2020	84,022
1.1/2"	1.1/2"	AFFDG2424	56,833	AMF90G2424	88,309	AFF90G2424	109,443	AMF45G2424	101,328	AFF45G2424	119,434
2"	2"	AFFDG3232	104,158	AMF90G3232	157,626	AFF90G3232	189,223	AMF45G3232	170,963	AFF45G3232	192,358

SERIE COMPATTA

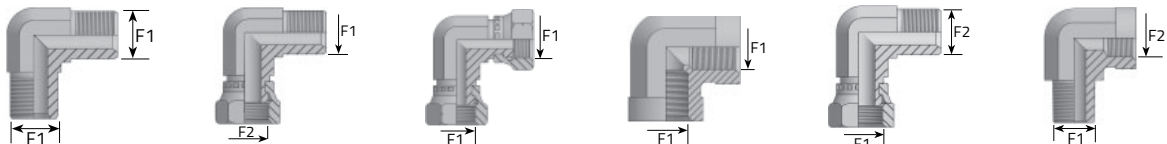

FILETTO		GOMITO 90° M GAS CIL SV 60° M GAS CIL SV 60°		GOMITO 90° M GAS CIL SV 60° F GIR GAS CIL SV 60°		GOMITO 90° F GIR GAS CIL SV 60° F GIR GAS CIL SV 60°		GOMITO 90° F FISSA GAS CIL SV 60° F FISSA GAS CIL SV 60°		GOMITO 90° M GAS CON F GIR GAS CIL SV 60°		GOMITO 90° M GAS CON F FISSA GAS CIL SV 60°	
F1	F2	Codice	€	Codice	€	Codice	€	Codice	€	Codice	€	Codice	€
1/8"	1/8"	LMG02	4,923	LMG02FGG02	7,823	LFGG02	20,829	LFFG02	5,164	LMGK02FGG02	7,664	LMGK02FFG02	7,346
1/4"	1/4"	LMG04	4,363	LMG04FGG04	8,885	LFGG04	18,749	LFFG04	5,501	LMGK04FGG04	10,322	LMGK04FFG04	6,487
3/8"	3/8"	LMG06	6,252	LMG06FGG06	11,028	LFGG06	39,165	LFFG06	6,932	LMGK06FGG06	11,677	LMGK06FFG06	9,381
1/2"	1/2"	LMG08	9,317	LMG08FGG08	11,461	LFGG08	45,410	LFFG08	8,802	LMGK08FGG08	14,424	LMGK08FFG08	13,458
5/8"	5/8"	LMG10	14,583										
3/4"	3/4"	LMG12	15,703	LMG12FGG12	21,529	LFGG12	48,463	LFFG12	18,419	LMGK12FGG12	20,632	LMGK12FFG12	19,850
1"	1"	LMG16	25,128	LMG16FGG16	36,659	LFGG16	50,689	LFFG16	26,515	LMGK16FGG16	40,176	LMGK16FFG16	32,391
1.1/4"	1.1/4"	LMG20	51,936	LMG20FGG20	69,299	LFGG20	58,328			LMGK20FGG20	73,884		
1.1/2"	1.1/2"			LMG24FGG24	-								



# ADATTATORI BSPP/GAS

disponibili anche INOX

OLEODINAMICA

SERIE COMPATTA

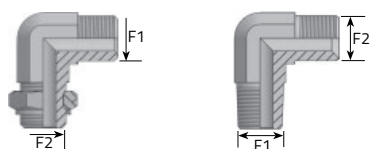

FILETTO		GOMITO 90° M GAS CIL M ORIENT G AS CIL SV 60°		GOMITO 90° M GAS CON M GAS CIL SV 60°	
F1	F2	Codice	€	Codice	€
1/8"	1/8"	LMG02MOG02	14,304	LMGK02MG02	4,891
1/8"	1/4"	LMG02MOG04	15,277		
1/4"	1/4"	LMG04MOG04	14,583	LMGK04MG04	4,929
1/4"	3/8"	LMG04MOG06	18,196		
3/8"	3/8"	LMG06MOG06	18,749	LMGK06MG06	6,837
3/8"	1/2"	LMG06MOG08	21,815		
1/2"	1/2"	LMG08MOG08	13,280	LMGK08MG08	10,729
1/2"	5/8"			LMGK08MG10	33,333
1/2"	3/4"	LMG08MOG12	35,005		
3/4"	1/2"	LMG12MOG08	32,633		
3/4"	3/4"	LMG12MOG12	33,333	LMGK12MG12	16,218
3/4"	1"	LMG12MOG16	44,717		
1"	1"	LMG16MOG16	47,636	LMGK16MG16	22,686
1.1/4"	1.1/4"			LMGK20MG20	47,655

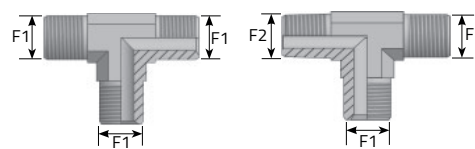

FILETTO		ADATT. "T" M-M GAS CIL SV 60°		ADATT. "T" M-M GAS CIL SV 60° M GAS CON AL BRACCIO	
F1	F2	Codice	€	Codice	€
1/8"	1/8"	TMG02	6,831	TMG02MGK02B	33,015
1/4"	1/4"	TMG04	6,093	TMG04MGK04B	33,708
3/8"	3/8"	TMG06	11,334	TMG06MGK06B	13,947
1/2"	1/2"	TMG08	15,003	TMG08MGK08B	36,551
5/8"	5/8"	TMG10	24,969		
3/4"	3/4"	TMG12	23,793	TMG12MGK12B	52,680
1"	1"	TMG16	36,239	TMG16MGK16B	62,665
1.1/4"	1.1/4"	TMG20	54,066	TMG20MGK20B	81,421

SERIE COMPATTA

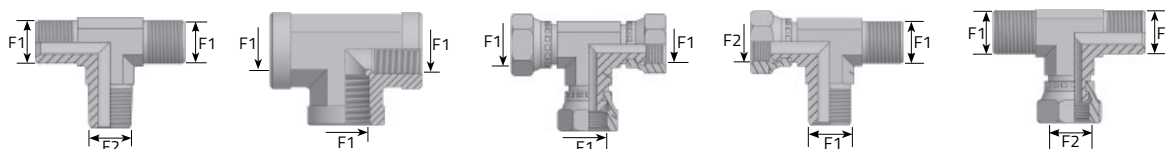

FILETTO		ADATT. "T" M-M GAS CIL SV 60 M GAS CON AL PIEDE		ADATT. "T" F-F-F FISSA GAS CIL		ADATT. "T" FG-FG-FG CIL		ADATT. "T" M-M GAS CIL SVB 60° FG GAS CIL AL BRACCIO		ADATT. "T" M-M GAS CIL SV 60° FG GAS CIL AL PIEDE	
F1	F2	Codice	€	Codice	€	Codice	€	Codice	€	Codice	€
1/8"	1/8"	TMG02MGK02P	33,015	TFFG02	5,769	TFFG02	18,609	TMG02FGG02B	12,249	TMG02FGG02P	12,249
1/4"	1/4"	TMG04MGK04P	33,708	TFFG04	8,109	TFFG04	19,996	TMG04FGG04B	11,791	TMG04FGG04P	11,791
3/8"	3/8"	TMG06MGK06P	13,947	TFFG06	10,863	TFFG06	41,524	TMG06FGG06B	15,029	TMG06FGG06P	15,029
1/2"	1/2"	TMG08MGK08P	39,693	TFFG08	16,790	TFFG08	23,443	TMG08FGG08B	21,395	TMG08FGG08P	21,395
5/8"	5/8"										
3/4"	3/4"	TMG12MGK12P	52,680	TFFG12	26,451	TFFG12	33,078	TMG12FGG12B	30,649	TMG12FGG12P	30,649
1"	1"	TMG16MGK16P	62,665	TFFG16	47,312	TFFG16	53,589	TMG16FGG16B	54,257	TMG16FGG16P	54,257
1.1/4"	1.1/4"	TMG20MGK20P	81,421			TFFG20	100,520	TMG20FGG20B	64,414	TMG20FGG20P	64,414

SERIE COMPATTA



FILETTO		ADATT. "T" M-M GAS CIL SV 60° M CIL ORIENT AL BRACCIO		ADATT. "T" M-M GAS CIL SV 60° M CIL ORIENT AL PIEDE	
F1	F2	Codice	€	Codice	€
1/8"	1/8"	TMG02MOG02B	18,539	TMG02MOG02P	18,539
1/8"	1/4"	TMG02MOG04B	22,419	TMG02MOG04P	22,419
1/4"	1/4"	TMG04MOG04B	21,789	TMG04MOG04P	21,789
1/4"	3/8"	TMG04MOG06B	26,540	TMG04MOG06P	26,540
3/8"	3/8"	TMG06MOG06B	27,793	TMG06MOG06P	27,793
3/8"	1/2"	TMG06MOG08B	26,795	TMG06MOG08P	26,795
1/2"	1/2"	TMG08MOG08B	28,385	TMG08MOG08P	28,385
3/4"	1/2"	TMG12MOG08B	50,422	TMG12MOG08P	50,422
3/4"	3/4"	TMG12MOG12B	49,570	TMG12MOG12P	49,570
3/4"	1"	TMG12MOG16B	51,783	TMG12MOG16P	51,783
1"	1"	TMG16MOG16B	64,834	TMG16MOG16P	64,834

FILETTO	TRONCHETTO A SALDARE - MASCHIO GAS CIL SV 60°		BORCHIA A SALDARE - GAS CILINDRICA	
F1	Codice	€	Codice	€
1/8"	ATSG02	1,685	ABSG02	1,482
1/4"	ATSG04	1,081	ABSG04	1,240
3/8"	ATSG06	1,406	ABSG06	1,660
1/2"	ATSG08	1,774	ABSG08	2,150
5/8"	ATSG10	4,376	ABSG10	4,827
3/4"	ATSG12	3,186	ABSG12	2,557
1"	ATSG16	6,010	ABSG16	6,373
1.1/4"	ATSG20	15,709	ABSG20	10,717
1.1/2"	ATSG24	25,764	ABSG24	12,707
2"	ATSG32	40,723	ABSG32	27,971



## ADATTATORI BSPP/GAS

disponibili anche INOX

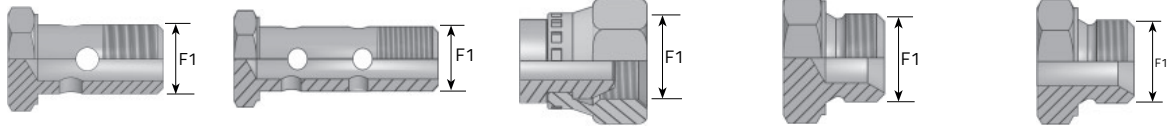

FILETTO	BULLONE FORATO - GAS CILINDRICO		BULLONE FORATO DOPPIO - GAS CILINDRICO		TAPPO FEMMINA GIREVOLE - GAS CILINDRICA SV 60°		TAPPO MASCHIO - GAS CILINDRICO SV 60°		NIPLES DIRITTO A SALDARE - MASCHIO GAS CIL SV 60°	
	F1	Codice	€	Codice	€	Codice	€	Codice	€	Codice
1/8"	ABFG02	2,092	ABFDG02	3,314	ATFG02	2,321	ATMG02	1,113	AMNS02	1,285
1/4"	ABFG04	1,774	ABFDG04	3,473	ATFG04	2,003	ATMG04	1,088	AMNS04	1,075
3/8"	ABFG06	2,175	ABFDG06	5,209	ATFG06	2,480	ATMG06	1,323	AMNS06	1,418
1/2"	ABFG08	3,275	ABFDG08	7,085	ATFG08	3,638	ATMG08	1,819	AMNS08	1,876
5/8"	ABFG10	10,914	ABFDG10	12,516	ATFG10	5,470	ATMG10	3,231	AMNS10	3,479
3/4"	ABFG12	6,335	ABFDG12	17,426	ATFG12	5,381	ATMG12	3,002	AMNS12	3,085
1"	ABFG16	15,315	ABFDG16	35,343	ATFG16	8,764	ATMG16	4,713	AMNS16	5,037
1.1/4"	ABFG20	40,068	ABFDG20	59,517	ATFG20	20,263	ATMG20	13,165	AMNS20	13,649
1.1/2"	ABFG24	50,352	ABFDG24	-	ATFG24	28,779	ATMG24	16,568	AMNS24	19,582
2"					ATFG32	49,614	ATMG32	38,542	AMNS32	54,054

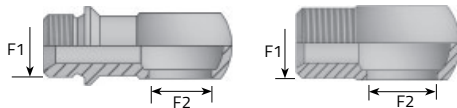

FORO		OCCHIO GAS CILINDRICO - MASCHIO GAS CILINDRICO SV 60° CON FILETTO		OCCHIO GAS CILINDRICO - MASCHIO GAS CILINDRICO SV 60°	
F1	F2	Codice	€	Codice	€
1/8"	1/8"			AOFG0202	4,401
1/4"	1/4"	AOFG0404B	4,248	AOFG0404	3,485
1/4"	3/8"	AOFG0604B	5,190	AOFG0604	5,145
3/8"	3/8"	AOFG0606B	4,675	AOFG0606	4,026
1/2"	3/8"	AOFG0608B	10,004	AOFG0608	6,684
1/4"	1/2"			AOFG0804	10,042
3/8"	1/2"	AOFG0806B	10,042	AOFG0806	8,001
1/2"	1/2"	AOFG0808B	6,888	AOFG0808	8,319
1/2"	3/4"			AOFG1208	25,052
3/4"	3/4"	AOFG1212B	29,059	AOFG1212	20,912
3/4"	1"			AOFG1612	53,348
1"	1"	AOFG1616B	57,552	AOFG1616	49,468

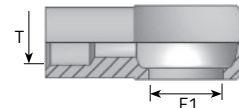

FORO	TASCA	OCCHIO A SALDARE - GAS CILINDRICO		FORO	TASCA	OCCHIO A SALDARE - GAS CILINDRICO	
F1	T mm.	Codice	€	F1	T mm.	Codice	€
1/8"	6	AOSG0206	2,716	1/2"	14	AOSG0814	7,257
1/4"	6	AOSG0406	4,795	1/2"	15	AOSG0815	7,257
1/4"	8	AOSG0408	2,919	1/2"	16	AOSG0816	7,257
1/4"	10	AOSG0410	2,919	1/2"	18	AOSG0818	6,398
1/4"	12	AOSG0412	2,919	5/8"	18	AOSG1018	9,553
3/8"	10	AOSG0610	4,261	5/8"	22	AOSG1022	9,680
3/8"	12	AOSG0612	4,261	3/4"	18	AOSG1218	16,345
3/8"	14	AOSG0614	4,827	3/4"	20	AOSG1220	16,345
3/8"	15	AOSG0615	5,400	3/4"	22	AOSG1222	16,345
1/2"	12	AOSG0812	7,257	1"	25	AOSG1625	60,566
				1"	27	AOSG1627	60,566

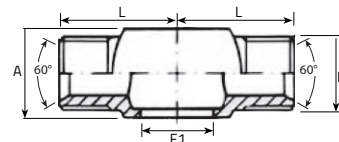

Filetto	ANELLO FILETTATO 2 VIE GAS				
F1	A (mm)	B	L (mm)	Codice	€
1/4"	14	1/4"	24	AO2V04	10,367
3/8"	28	3/8"	28	AO2V06	12,847
1/2"	32	1/2"	32	AO2V08	14,730

## RACCORDI AD OCCHIO PER VALVOLE SERIE DIN 2353

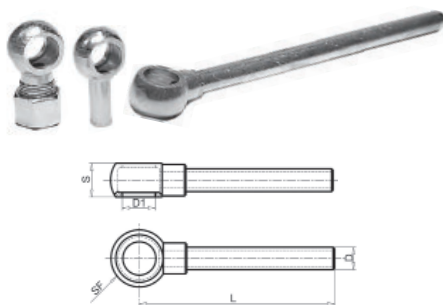

OCCHIO GAS CON TUBETTO						
D	D1	S	L (mm)	SF	Codice	€
10	1/4	14	40	24	AOG04PDL10-40	8,268
10	1/4	14	100	24	AOG04PDL10-100	7,632
10	1/4	14	200	24	AOG04PDL10-200	12,720
10	1/4	14	300	24	AOG04PDL10-300	10,176
10	1/4	14	400	24	AOG04PDL10-400	19,080
12	1/4	15	40	24	AOG04PDL12-40	6,360
12	1/4	15	100	24	AOG04PDL12-100	11,448
12	1/4	15	200	24	AOG04PDL12-200	15,455
12	1/4	15	300	24	AOG04PDL12-300	22,260
12	1/4	15	400	24	AOG04PDL12-400	28,620

OCCHIO GAS CON TUBETTO						
D	D1	S	L (mm)	SF	Codice	€
12	3/8	17	40	28	AOG06PDL12-40	6,996
12	3/8	17	51	28	AOG06PDL12-51	6,996
12	3/8	17	100	28	AOG06PDL12-100	8,904
12	3/8	17	150	28	AOG06PDL12-150	10,176
12	3/8	17	200	28	AOG06PDL12-200	10,812
12	3/8	17	300	28	AOG06PDL12-300	11,448
12	3/8	17	400	28	AOG06PDL12-400	29,892
15	1/2	22	100	35	AOG08PDL15-100	17,808
15	1/2	22	200	35	AOG08PDL15-200	18,762
15	1/2	22	300	35	AOG08PDL15-300	21,624



# ADATTATORI METRICI

disponibili anche INOX

OLEODINAMICA

SERIE STANDARD

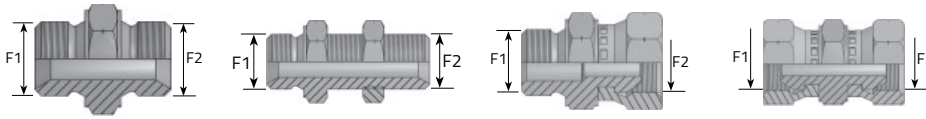

FILETTO		NIPLES DIRITTO M-M METRICO SV 60°		NIPLES PASSAPARETE M-M METRICO SV 60°		NIPLES DIRITTO M METRICO SV 60° F GIR METRICA		NIPLES DIRITTO F GIR METRICA	
F1	F2	Codice	€	Codice	€	Codice	€	Codice	€
10x1	10x1	ANMM1010	1,431					AFFDM1010	4,083
12x1.5	12x1.5	ANMM1212	1,501			AMFDM1212	3,269	AFFDM1212	4,223
14x1.5	14x1.5	ANMM1414	1,615	ANMM1414P	6,945	AMFDM1414	3,441	AFFDM1414	4,471
16x1.5	16x1.5	ANMM1616	2,436	ANMM1616P	10,418	AMFDM1616	4,242	AFFDM1616	5,393
18x1.5	18x1.5	ANMM1818	2,779	ANMM1818P	10,558	AMFDM1818	4,465	AFFDM1818	5,412
20x1.5	20x1.5	ANMM2020	2,983			AMFDM2020	5,272	AFFDM2020	6,805
22x1.5	22x1.5	ANMM2222	3,142	ANMM2222P	15,830	AMFDM2222	5,355	AFFDM2222	6,920
24x1.5	24x1.5	ANMM2424	5,781			AMFDM2424	6,805	AFFDM2424	8,662
26x1.5	26x1.5	ANMM2626	6,080			AMFDM2626	8,478	AFFDM2626	9,788
28x1.5	28x1.5	ANMM2828	10,984						
30x1.5	30x1.5	ANMM3030	14,081			AMFDM3030	10,767		

SERIE STANDARD

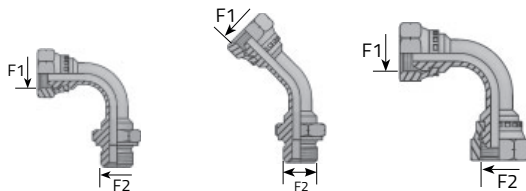

SERIE COMPATTA

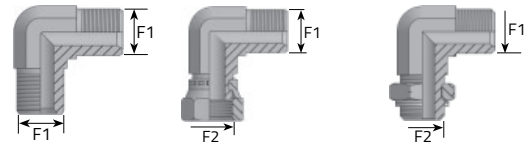

FILETTO		CURVA 90° M METRICO SV 60° F GIR METRICA		CURVA 45° M METRICO SV 60° F GIR METRICA		CURVA 90° F GIR METRICA		FILETTO		GOMITO 90° M METRICO SV 60°		GOMITO 90° M METRICO SV 60° F GIR METRICA		GOMITO 90° M METRICO OR SV 60°	
F1	F2	Codice	€	Codice	€	Codice	€	F1	F2	Codice	€	Codice	€	Codice	€
10x1	10x1	AMF90M1010	5,622	AMF45M1010	6,252	AFF90M1010	5,489	10x1	12x1.5			LMM10MOMR12	33,269	LMM10MOMR12	33,269
12x1.5	12x1.5	AMF90M1212	6,239	AMF45M1212	6,525	AFF90M1212	5,489	12x1.5	12x1.5	LMM12	24,359	LMM12FGM12	11,11	LMM12MOMR12	34,090
14x1.5	14x1.5	AMF90M1414	5,540	AMF45M1414	5,489	AFF90M1414	5,005	12x1.5	14x1.5			LMM12MOMR14	34,102	LMM12MOMR14	34,102
16x1.5	16x1.5	AMF90M1616	7,180	AMF45M1616	7,180	AFF90M1616	6,239	14x1.5	14x1.5	LMM14	24,950	LMM14FGM14	12,83	LMM14MOMR14	34,319
18x1.5	18x1.5	AMF90M1818	8,268	AMF45M1818	7,778	AFF90M1818	6,239	16x1.5	16x1.5	LMM16	27,030	LMM16FGM16	15,71	LMM14MOMR16	36,697
20x1.5	20x1.5	AMF90M2020	9,578	AMF45M2020	9,724	AFF90M2020	7,498	16x1.5	16x1.5	LMM16	27,030	LMM16FGM16	15,71	LMM16MOMR16	36,945
22x1.5	22x1.5	AMF90M2222	9,667	AMF45M2222	9,788	AFF90M2222	7,638	16x1.5	18x1.5	LMM18	27,113	LMM18FGM18	17,22	LMM16MOMR18	37,009
24x1.5	24x1.5	AMF90M2424	17,032	AMF45M2424	17,083	AFF90M2424	13,191	18x1.5	18x1.5	LMM18	27,113	LMM18FGM18	17,22	LMM18MOMR18	37,251
26x1.5	26x1.5	AMF90M2626	18,463	AMF45M2626	18,749	AFF90M2626	14,444	14x1.5	22x1.5	LMM20	29,097	LMM20FGM20	19,18	LMM18MOMR22	39,527
28x1.5	28x1.5							20x1.5	20x1.5	LMM20	29,097	LMM20FGM20	19,18	LMM22MOMR22	40,106
30x1.5	30x1.5							22x1.5	22x1.5	LMM22	29,097	LMM22FGM22	19,27	LMM26MOMR22	47,337
								26x1.5	22x1.5	LMM26	38,160	LMM26FGM26	27,882	LMM26MOMR27	48,209
								26x1.5	27x2					LMM30MOMR27	54,372
								30x1.5	27x2						
								30x1.5	30x1.5	LMM30	44,291	LMM30FGM30	35,49	LMM30MOMR27	54,372
								30x1.5	33x2					LMM30MOMR33	56,528

SERIE COMPATTA

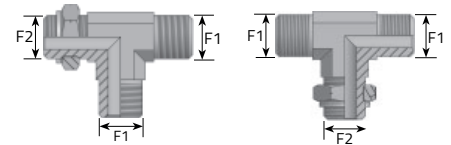
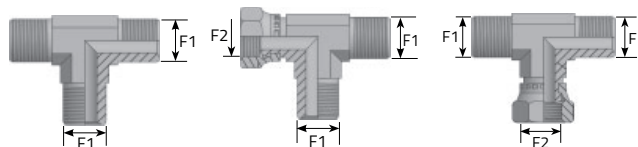

FILETTO		ADATT. "T" M METRICO SV 60°		ADATT. "T" M METRICO SV 60° FG METRICA AL BRACCIO		ADATT. "T" M METRICO SV 60° FG METRICA AL PIEDE		FILETTO		ADATT. "T" M METRICO SV 60° M TRICO OR AL BRACCIO		ADATT. "T" M METRICO SV 60° M TRICO OR AL PIEDE	
F1	F2	Codice	€	Codice	€	Codice	€	F1	F2	Codice	€	Codice	€
10x1	10x1	TMM10	33,015					10x1	12x1.5	TMM10MOMR12B	43,191	TMM10MOMR12P	43,191
12x1.5	12x1.5	TMM12	33,015	TMM12FGM12B	41,181	TMM12FGM12P	41,181	12x1.5	12x1.5	TMM12MOMR12B	44,456	TMM12MOMR12P	44,456
14x1.5	14x1.5	TMM14	20,180	TMM14FGM14B	42,224	TMM14FGM14P	42,224	12x1.5	14x1.5	TMM12MOMR14B	44,507	TMM12MOMR14P	44,507
16x1.5	16x1.5	TMM16	24,759	TMM16FGM16B	46,072	TMM16FGM16P	46,072	14x1.5	14x1.5	TMM14MOMR14B	44,711	TMM14MOMR14P	44,711
18x1.5	18x1.5	TMM18	25,554	TMM18FGM18B	46,523	TMM18FGM18P	46,523	14x1.5	16x1.5	TMM14MOMR16B	48,724	TMM14MOMR16P	48,724
20x1.5	20x1.5	TMM20	34,299	TMM20FGM20B	50,467	TMM20FGM20P	50,467	16x1.5	16x1.5	TMM16MOMR16B	48,978	TMM16MOMR16P	48,978
22x1.5	22x1.5	TMM22	36,010	TMM22FGM22B	27,424	TMM22FGM22P	27,424	16x1.5	18x1.5	TMM16MOMR18B	49,067	TMM16MOMR18P	49,067
26x1.5	26x1.5	TMM26	42,707	TMM26FGM26B	58,944	TMM26FGM26P	58,944	18x1.5	18x1.5	TMM18MOMR18B	49,315	TMM18MOMR18P	49,315
30x1.5	30x1.5	TMM30	47,051	TMM30FGM30B	66,984	TMM30FGM30P	66,984	18x1.5	22x1.5	TMM18MOMR22B	52,483	TMM18MOMR22P	52,483
								22x1.5	22x1.5	TMM22MOMR22B	53,061	TMM22MOMR22P	53,061
								26x1.5	22x1.5	TMM26MOMR22B	63,098	TMM26MOMR22P	63,098
								26x1.5	27x2	TMM26MOMR27B	63,950	TMM26MOMR27P	63,950
								30x1.5	27x2	TMM30MOMR27B	73,159	TMM30MOMR27P	73,159
								30x1.5	33x2	TMM30MOMR33B	75,321	TMM30MOMR33P	75,321



# ADATTATORI METRICI

disponibili anche INOX

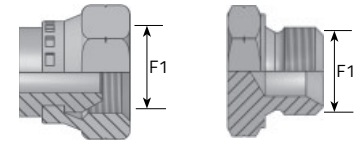
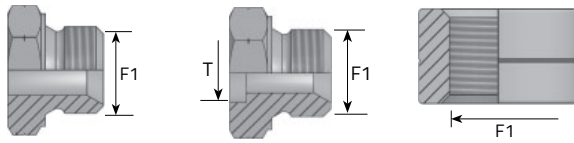

FILETTO	NIPLES DIRITTO A SALDARE - M METRICO SV 60°		NIPLES DIRITTO A SALDARE - M METRICO SV 60° CON TASCA		BORCHIA A SALDARE METRICA SV 60°		
	F1	Codice	€	Codice	€	Codice	€
10x1	AMNSM10	1,908					
12x1.5	AMNSM12	1,571			ABSM12	1,914	
14x1.5	AMNSM14	1,577		AMNSM14T10	1,755	ABSM14	1,641
14x1.5				AMNSM14T12	1,755		
16x1.5	AMNSM16	1,895		AMNSM16T12	2,309	ABSM16	1,768
18x1.5	AMNSM18	2,080		AMNSM18T14	2,824	ABSM18	1,978
18x1.5				AMNSM18T15	2,824		
20x1.5	AMNSM20	2,385				ABSM20	2,690
22x1.5	AMNSM22	2,652		AMNSM22T16	3,517	ABSM22	2,690
22x1.5				AMNSM22T22	3,517		
24x1.5	AMNSM24	3,930					
26x1.5	AMNSM26	4,248					

FILETTO	TAPPO FEMMINA GIREVOLE METRICA		TAPPO MASCHIO METRICO SV 60°		
	F1	Codice	€	Codice	€
8x1				ATMM08	1,596
10x1	ATFM10	3,504		ATMM10	1,476
10x1.5				ATMM10X1.5	0,000
12x1.5	ATFM12	3,123		ATMM12	1,482
14x1.5	ATFM14	2,703		ATMM14	1,317
16x1.5	ATFM16	3,326		ATMM16	1,825
18x1.5	ATFM18	3,930		ATMM18	1,794
20x1.5	ATFM20	3,848		ATMM20	2,436
22x1.5	ATFM22	3,962		ATMM22	2,423
24x1.5	ATFM24	7,683		ATMM24	3,988
26x1.5	ATFM26	7,193		ATMM26	4,147
28x1.5	ATFM28	13,629		ATMM28	5,934
30x1.5	ATFM30	15,003		ATMM30	7,168

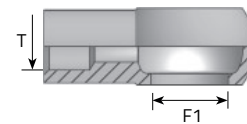
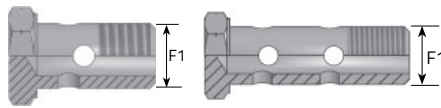

FILETTO	BULLONE FORATO METRICO		BULLONE FORATO DOPPIO METRICO		
	F1	Codice	€	Codice	€
6x1	ABFM06	2,067			
8x1	ABFM08	2,741		ABFDM08	3,638
8x1.25	ABFM08X1.25	2,099		ABFDM08X1.25	4,827
8x1.5	ABFM08X1.5	2,442			
10x1	ABFM10	1,704		ABFDM10	3,428
10x1.25	ABFM10X1.25	2,112		ABFDM10X1.25	5,056
10x1.5	ABFM10X1.5	2,112			
12x1.5	ABFM12	1,819		ABFDM12	4,248
12x1	ABFM12X1	1,978			
12x1.25	ABFM12X1.25	1,819		ABFDM12X1.25	5,031
14x1.5	ABFM14	1,762		ABFDM14	4,350
16x1.5	ABFM16	3,511		ABFDM16	6,837
18x1.5	ABFM18	3,702		ABFDM18	7,848
20x1.5	ABFM20	4,605		ABFDM20	11,149
22x1.5	ABFM22	4,700		ABFDM22	12,275
24x1.5	ABFM24	6,080			
24x2	ABFM24X2	7,562			
26x1.5	ABFM26	7,295		ABFDM26	19,519
30x1.5	ABFM30	19,303			

FORO	TASCA	OCCHIO A SALDARE METRICO		FORO	TASCA	OCCHIO A SALDARE METRICO	
		F1	T mm.			Codice	€
6	4			18	16	AOSM1816	6,055
8	4	AOSM0804	2,213	18	18	AOSM1818	6,773
8	5	AOSM0805	2,283	20	10	AOSM2010	7,257
8	6	AOSM0806	2,283	20	12	AOSM2012	7,257
10	6	AOSM1006	2,340	20	14	AOSM2014	7,257
10	8	AOSM1008	2,697	20	15	AOSM2015	7,257
12	6	AOSM1206	2,976	20	16	AOSM2016	9,616
12	8	AOSM1208	2,976	22	10	AOSM2210	9,616
12	10	AOSM1210	2,976	22	12	AOSM2212	9,616
14	6	AOSM1406	3,180	22	14	AOSM2214	9,616
14	8	AOSM1408	3,180	22	15	AOSM2215	9,616
14	10	AOSM1410	3,180	22	16	AOSM2216	9,616
14	12	AOSM1412	3,180	22	18	AOSM2218	9,616
16	10	AOSM1610	4,159	22	20	AOSM2220	11,677
16	12	AOSM1612	3,600	24	16	AOSM2416	16,097
16	14	AOSM1614	5,024	24	18	AOSM2418	16,097
18	10	AOSM1810	6,055	24	20	AOSM2420	16,097
18	12	AOSM1812	5,018	26	20	AOSM2620	15,353
18	14	AOSM1814	5,018	26	22	AOSM2622	15,353
18	15	AOSM1815	4,338	30	28	AOSM3028	42,275

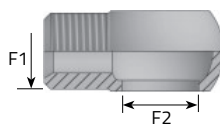

FILETTO	FORO	OCCHIO MASCHIO METRICO SV 60°		
		F2	Codice	€
14x1.5	1/4"		AOFGM0414	4,751
14x1.5	3/8"		AOFGM0614	5,813
16x1.5	3/8"		AOFGM0616	6,252
18x1.5	3/8"		AOFGM0618	7,403
18x1.5	1/2"		AOFGM0818	9,394
22x1.5	1/2"		AOFGM0822	10,526

OLEODINAMICA





# RIDUZIONI BSPP/GAS

disponibili anche INOX

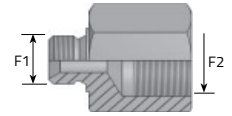
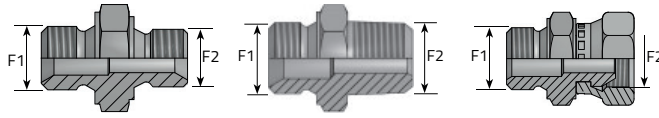

FILETTO		NIPLES DIRITTO M GAS CILINDRICO SV 60°		NIPLES DIRITTO M GAS CILINDRICO SV 60° M GAS CONICO		NIPLES DIRITTO M GAS CILINDRICO SV 60° F GIR GAS CILINDRICA	
F1	F2	Codice	€	Codice	€	Codice	€
1/8"	1/4"					AMFDG0204	5,972
1/4"	1/8"	ARGG0402	1,221	ARGK0402	1,794		
1/4"	3/8"					AMFDG0406	4,643
1/4"	1/2"					AMFDG0408	6,239
3/8"	1/8"	ARGG0602	2,213	ARGK0602	2,538		
3/8"	1/4"	ARGG0604	1,507	ARGK0604	2,379	AMFDG0604	5,597
3/8"	1/2"					AMFDG0608	4,821
3/8"	3/4"					AMFDG0612	11,976
1/2"	1/4"	ARGG0804	2,410	ARGK0804	2,856	AMFDG0804	9,915
1/2"	3/8"	ARGG0806	2,086	ARGK0806	3,142	AMFDG0806	9,915
1/2"	3/4"					AMFDG0812	7,785
5/8"	3/8"	ARGG1006	3,543	ARGK1006	-		
5/8"	1/2"	ARGG1008	3,543	ARGK1008	-		
3/4"	1/4"	ARGG1204	3,956	ARGK1204	6,341		
3/4"	3/8"	ARGG1206	3,759	ARGK1206	6,341	AMFDG1206	11,397
3/4"	1/2"	ARGG1208	3,307	ARGK1208	5,094	AMFDG1208	10,933
3/4"	5/8"	ARGG1210	3,835				
3/4"	1"					AMFDG1216	11,397
1"	3/8"	ARGG1606	7,568	ARGK1606	11,353		
1"	1/2"	ARGG1608	6,354	ARGK1608	10,857		
1"	5/8"	ARGG1610	8,077				
1"	3/4"	ARGG1612	6,163	ARGK1612	8,790	AMFDG1612	16,040
1"	1.1/4"					AMFDG1620	28,423
1.1/4"	1/2"	ARGG2008	16,415				
1.1/4"	3/4"	ARGG2012	14,609				
1.1/4"	1"	ARGG2016	13,852			AMFDG2016	36,723
1.1/4"	1.1/2"					AMFDG2024	40,551
1.1/2"	3/4"	ARGG2412	18,978				
1.1/2"	1"	ARGG2416	17,916				
1.1/2"	1.1/4"	ARGG2420	17,083			AMFDG2420	43,356
1.1/2"	2"					AMFDG2432	61,253
2"	1"	ARGG3216	38,866				
2"	1.1/4"	ARGG3220	37,797				
2"	1.1/2"	ARGG3224	37,346			AMFDG3224	104,018

FILETTO		RID. LUNGA M CILINDRICO SV 60° F FISSA GAS CILINDRICA	
F1	F2	Codice	€
1/8"	1/4"	ARMFLO204	2,181
1/8"	3/8"	ARMFLO206	2,716
1/4"	1/8"	ARMFLO402	2,703
1/4"	3/8"	ARMFLO406	2,538
1/4"	1/2"	ARMFLO408	3,129
1/4"	3/4"	ARMFLO412	6,564
3/8"	1/4"	ARMFLO604	2,499
3/8"	1/2"	ARMFLO608	3,606
3/8"	3/4"	ARMFLO612	6,945
3/8"	1"	ARMFLO616	11,410
1/2"	1/4"	ARMFLO804	3,822
1/2"	3/8"	ARMFLO806	3,619
1/2"	3/4"	ARMFLO812	6,042
1/2"	1"	ARMFLO816	12,154
1/2"	1.1/4"	ARMFLO820	29,841
1/2"	1.1/2"	ARMFLO824	35,546
3/4"	1/4"	ARMFL1204	9,642
3/4"	3/8"	ARMFL1206	7,066
3/4"	1/2"	ARMFL1208	5,908
3/4"	1"	ARMFL1212	0,000
3/4"	1.1/4"	ARMFL1220	27,405
3/4"	1.1/2"	ARMFL1224	28,734
1"	3/8"	ARMFL1606	9,305
1"	1/2"	ARMFL1608	9,305
1"	3/4"	ARMFL1612	10,780
1"	1.1/4"	ARMFL1620	20,148
1"	1.1/2"	ARMFL1624	36,144
1"	2"	ARMFL1632	54,047
1.1/4"	3/4"	ARMFL2012	27,011
1.1/4"	1"	ARMFL2016	27,819
1.1/4"	1.1/2"	ARMFL2024	35,374
1.1/4"	2"	ARMFL2032	69,903
1.1/2"	3/4"	ARMFL2412	41,683
1.1/2"	1"	ARMFL2416	39,737
1.1/2"	1.1/4"	ARMFL2420	29,847
1.1/2"	2"	ARMFL2432	56,318
2"	1"	ARMFL3216	67,963
2"	1.1/4"	ARMFL3220	67,963
2"	1.1/2"	ARMFL3224	61,883

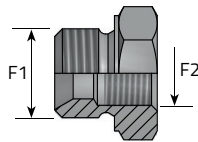

FILETTO		RID. CORTA M GAS CILINDRICO SV 60° F FISSA GAS CILINDRICA		FILETTO		RID. CORTA M GAS CILINDRICO SV 60° F FISSA GAS CILINDRICA	
F1	F2	Codice	€	F1	F2	Codice	€
1/4"	1/8"	ARMFC0402	-	1"	3/4"	ARMFC1612	7,365
3/8"	1/8"	ARMFC0602	2,391	1.1/4"	1/2"	ARMFC2008	20,632
3/8"	1/4"	ARMFC0604	2,258	1.1/4"	3/4"	ARMFC2012	15,627
1/2"	1/8"	ARMFC0802	4,312	1.1/4"	1"	ARMFC2016	13,191
1/2"	1/4"	ARMFC0804	2,989	1.1/2"	1/2"	ARMFC2408	21,719
1/2"	3/8"	ARMFC0806	2,989	1.1/2"	3/4"	ARMFC2412	28,811
3/4"	1/4"	ARMFC1204	4,954	1.1/2"	1"	ARMFC2416	18,749
3/4"	3/8"	ARMFC1206	4,516	1.1/2"	1.1/4"	ARMFC2420	23,526
3/4"	1/2"	ARMFC1208	4,306	2"	1"	ARMFC3216	39,693
1"	1/4"	ARMFC1604	8,192	2"	1.1/4"	ARMFC3220	38,300
1"	3/8"	ARMFC1606	7,600	2"	1.1/2"	ARMFC3224	42,733
1"	1/2"	ARMFC1608	7,295				

# RIDUZIONI BSPP/GAS-METRICO

disponibili anche INOX

OLEODINAMICA

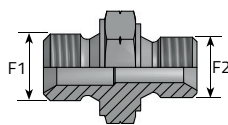

FILETTO		NIPLES DRETTO M GAS CILINDRICO SV 60° M METRICO SV 60°	
F1	F2	Codice	€
1/8"	10X1	ARGM0210	1,596
1/8"	12X1.5	ARGM0212	1,724
1/4"	10X1	ARGM0410	1,724
1/4"	12X1.5	ARGM0412	1,755
1/4"	14X1.5	ARGM0414	1,533
1/4"	16X1.5	ARGM0416	2,124
1/4"	18X1.5	ARGM0418	2,582
1/4"	22X1.5	ARGM0422	3,695
3/8"	12X1.5	ARGM0612	1,984
3/8"	14X1.5	ARGM0614	2,372
3/8"	16X1.5	ARGM0616	2,143
3/8"	18X1.5	ARGM0618	2,633
3/8"	20X1.5	ARGM0620	4,420
3/8"	22X1.5	ARGM0622	3,403
1/2"	12X1.5	ARGM0812	3,104
1/2"	14X1.5	ARGM0814	2,697
1/2"	16X1.5	ARGM0816	3,956
1/2"	18X1.5	ARGM0818	3,702
1/2"	20X1.5	ARGM0820	3,543
1/2"	22X1.5	ARGM0822	2,964
1/2"	24X1.5	ARGM0824	17,547
1/2"	26X1.5	ARGM0826	6,602
5/8"	18X1.5	ARGM1018	7,460
5/8"	20X1.5	ARGM1020	7,460
5/8"	22X1.5	ARGM1022	6,315
3/4"	18X1.5	ARGM1218	6,748
3/4"	20X1.5	ARGM1220	7,130
3/4"	22X1.5	ARGM1222	4,217
3/4"	26X1.5	ARGM1226	5,781
3/4"	30X1.5	ARGM1230	9,903
1"	22X1.5	ARGM1622	16,549
1"	26X1.5	ARGM1626	12,637
1"	30X1.5	ARGM1630	17,770
1.1/4"	30X1.5	ARGM2030	35,393
1.1/4"	38X1.5	ARGM2038	28,461

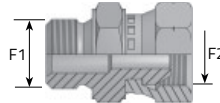

FILETTO		NIPLES DRETTO M GAS CILINDRICO SV 60° F METRICA GIR	
F1	F2	Codice	€
1/4"	14X1.5	AMFDGM0414	5,438
1/2"	22X1.5	AMFDGM0822	9,992

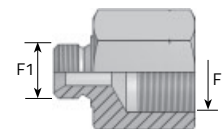

FILETTO		RID. LUNGA M GAS CILINDRICO SV 60° F FISSA METRICA	
F1	F2	Codice	€
1/4"	14X1.5	ARMFLM0414	4,376
3/8"	16X1.5	ARMFLM0616	5,050
3/8"	18X1.5	ARMFLM0618	4,681
1/2"	18X1.5	ARMFLM0818	4,255
1/2"	22X1.5	ARMFLM0822	4,598

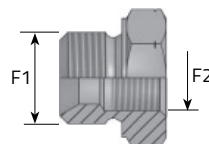

FILETTO		RID. CORTA M GAS CILINDRICO SV 60° F FISSA METRICA	
F1	F2	Codice	€
3/8"	12X1.5	ARMFCM0612	3,212
3/8"	14X1.5	ARMFCM0614	2,385
1/2"	12X1.5	ARMFCM0812	5,133
1/2"	14X1.5	ARMFCM0814	4,274

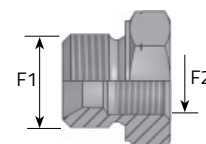

FILETTO		RID. CORTA M METRICO SV 60° F FISSA GAS CILINDRICA	
F1	F2	Codice	€
18x1.5	1/4"	ARMFCM1804	3,046
22x1.5	1/4"	ARMFCM2204	4,331
22x1.5	3/8"	ARMFCM2206	3,473

# RIDUZIONI METRICO-METRICO

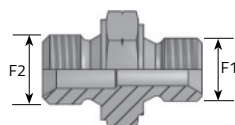

FILETTO		NIPLES DRETTO M METRICO SV 60°		FILETTO		NIPLES DRETTO M METRICO SV 60°	
F1	F2	Codice	€	F1	F2	Codice	€
10X1	12X1.5	ARMM1210	1,654	14X1.5	22X1.5	ARMM2214	3,428
10X1	14X1.5	ARMM1410	1,660	16x1.5	22X1.5	ARMM2216	3,288
12X1.5	14X1.5	ARMM1412	1,679	18X1.5	22X1.5	ARMM2218	3,492
12X1.5	16X1.5	ARMM1612	2,760	20X1.5	22X1.5	ARMM2220	3,352
14X1.5	16X1.5	ARMM1614	2,449	18X1.5	24X1.5	ARMM2418	5,565
14X1.5	18X1.5	ARMM1814	2,811	22X1.5	24X1.5	ARMM2422	6,233
16X1.5	18X1.5	ARMM1816	3,015	22X1.5	26X1.5	ARMM2622	6,729
14X1.5	20X1.5	ARMM2014	3,956	24X1.5	26x1.5	ARMM2624	6,074
16X1.5	20X1.5	ARMM2016	3,473	22X1.5	30X1.5	ARMM3022	11,206
18X1.5	20X1.5	ARMM2018	3,899	26X1.5	30X1.5	ARMM3026	11,340

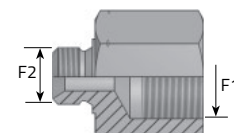

FILETTO		RID. LUNGA M METRICO SV 60° - F METRICA	
F1	F2	Codice	€
14X1.5	18X1.5	ARMFLM1814	6,150
22X1.5	18X1.5	ARMFLM1822	6,843
18X1.5	22X1.5	ARMFLM2218	6,843



# PROLUNGHE BSPP/GAS

disponibili anche INOX

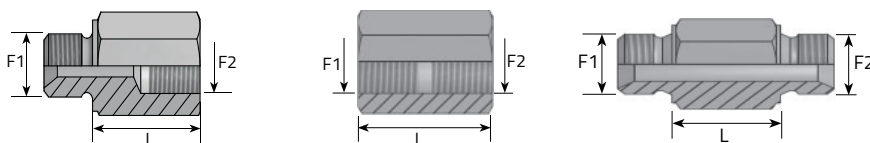

FILETTO		PROLUNGA M GAS CILINDRICO SV 60° F FISSA GAS CILINDRICA			PROLUNGA F FISSA GAS CILINDRICA			PROLUNGA M GAS CILINDRICO SV 60°		
F1	F2	L mm.	Codice	€	L mm.	Codice	€	L mm.	Codice	€
1/8"	1/8"	21	APMFG0230.5	2,697	25	APFFG0202	3,275			
1/4"	1/4"	22	APMFG0433	2,086	30	APFFG0404	2,919	26	APMMG0404	6,901
1/4"	1/4"	31	APMFG0442	2,042						
1/4"	1/4"	39	APMFG0450	2,188						
1/4"	1/4"	44	APMFG0455	2,423						
3/8"	3/8"	22.5	APMFG0635	2,499	35	APFFG0606	4,516	25	APMMG0606	7,715
3/8"	3/8"	26.5	APMFG0639	-						
3/8"	3/8"	29.5	APMFG0642	2,716						
3/8"	3/8"	41.5	APMFG0654	2,989						
1/2"	1/2"	26	APMFG0840	3,822	40	APFFG0808	3,861	28	APMMG0808	9,006
1/2"	1/2"	31	APMFG0845	3,759						
1/2"	1/2"	36	APMFG0850	4,261						
1/2"	1/2"	46	APMFG0860	4,859						
5/8"	5/8"				35	APFFG1010	7,200			
3/4"	3/4"	32	APMFG1248	5,311	40	APFFG1212	9,922	40	APMMG1212	17,236
3/4"	3/4"	41	APMFG1257	6,462						
3/4"	3/4"	51	APMFG1267	8,758						
3/4"	3/4"	56	APMFG1272	7,982						
1"	1"	36	APMFG1654	11,677	50	APFFG1616	12,917	49	APMMG1616	20,753
1"	1"	42	APMFG1660	10,577						
1"	1"	70	APMFG1680	12,612						
1.1/4"	1.1/4"	42	APMFG2062	24,397	55	APFFG2020	35,565	58	APMMG2020	49,036
1.1/4"	1.1/4"	72	APMFG2092	33,225						
1.1/2"	1.1/2"	43	APMFG2465	33,288	60	APFFG2424	41,092			
1.1/2"	1.1/2"	73	APMFG2495	48,915						
2"	2"	32	APMFG3257	80,314	54	APFFG3232	63,409			
2"	2"	37	APMFG3262	84,264						

# PROLUNGHE METRICHE

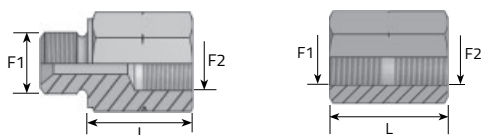

FILETTO		PROLUNGA M METRICO SV 60° F FISSA METRICA			PROLUNGA F FISSA METRICA		
F1	F2	L mm.	Codice	€	L mm.	Codice	€
10X1	10X1	17.5	APMFM1027	3,619			
10X1	10X1	31	APMFM1040.5	4,878			
14X1.5	14x1.5	22	APMFM1433	2,678	30	APFFM1414	4,306
16X1.5	16X1.5	22.5	APMFM1635	3,504	35	APFFM1616	5,177
18X1.5	18X1.5	26	APMFM1840	3,746	35	APFFM1818	8,790
18X1.5	18X1.5	31	APMFM1845	4,636			
18X1.5	18X1.5	36	APMFM1850	4,986			
20X1.5	20X1.5	31	APMFM2045	7,079			
20X1.5	20X1.5	46	APMFM2060	6,971			
22X1.5	22X1.5	26	APMFM2240	6,729	40	APFFM2222	6,805
22X1.5	22X1.5	46	APMFM2260	6,971			